

EXISTING FIRST FLOOR / SITE PLAN

SCALE: 3/32" = 1'-0"

LOT SIZE: 10,500 S.F. (APPROX)

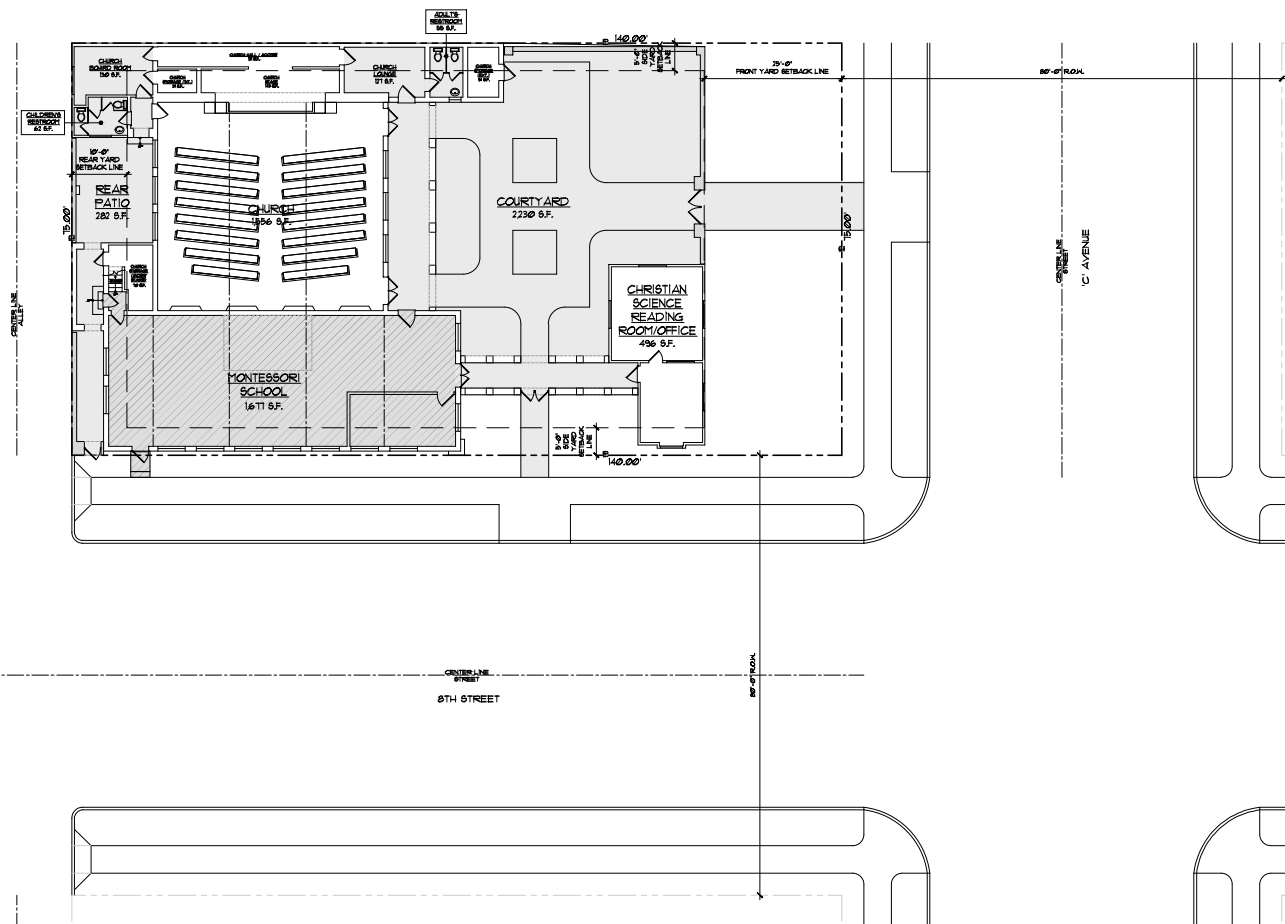

PROJECT INFORMATION

OWNER: FIRST CHURCH OF CHRIST SCIENTIST
1023 8TH STREET
CORONADO, CA 92118

APPLICANT: KEVIN RUGEE ARCHITECT, INC.
1024 ISABELLA AVENUE
CORONADO, CA 92118
(619) 522-9504

GOVERNING AGENCY: CITY OF CORONADO

PROJECT ADDRESS: 1023 8TH STREET
CORONADO, CA 92118

LEGAL DESCRIPTION: LOTS 1, 2, 3
BLOCK 69, MAP 316

APN: 531-091-22-00

ZONE: R-3

LOT AREA: 0.24 ACRE = 10,500 S.F. (APPROX)

CONSTRUCTION TYPE: 3B NON-SPRINKLERED

CURRENT BUILDING OCCUPANCY: A-3 CHURCH
B MONTESORRI SCHOOL OFFICE

SQUARE FOOTAGE CALCULATIONS

GROUND FLOOR:

CHURCH ASSEMBLY SPACE 1306 S.F.
CHURCH STAGE 143 S.F.
CHURCH HALL / ACCESS 31 S.F.
CHURCH STORAGE (INTERIOR) 31 S.F.
CHURCH STORAGE (EXTERIOR) 31 S.F.
CHURCH STORAGE (UNDER STAIRS) 10 S.F.
CHRISTIAN SCIENCE READING ROOM / OFFICE 436 S.F.

SHARED ACCESS FACILITIES:

REAR PATIO 282 S.F.
CHURCH BOARD ROOM 130 S.F.
CHILDREN'S RESTROOM 63 S.F.
CHURCH LOUNGE 31 S.F.
ADULTS RESTROOM 30 S.F.
COURTYARD 2350 S.F.

MONTESORRI SCHOOL 1671 S.F.

SECOND FLOOR:

CHURCH PIANO LOFT 09 S.F.

'MY MONTESORRI' SCHOOL

STAFF (TEACHERS, ADMINISTRATIVE) 4
STUDENTS 35 (MAX)
36 (CURRENT)

WALL LEGEND:

EXISTING WALL TO REMAIN
EXISTING SITE WALL TO REMAIN

USE LEGEND:

SHARED FACILITIES
MONTESORRI SCHOOL USE ONLY
CHURCH USE ONLY

REVISIONS	BY
MSUP SUBMITTAL 03-23	
PLAN CHECK SUBMITTAL 03/23/24	
PLAN CHECK CORRECTIONS 03/23/24	KHR

1024 ISABELLA AVENUE
CORONADO, CA 92118
(619) 522-9504

KEVIN RUGEE
ARCHITECT INC.
ESTABLISHED 1986



COPYRIGHT © 2025

MONTESORRI SCHOOL
SPECIAL USE PERMIT
1123 8TH STREET
CORONADO, CA 92118

DATE	03-25-24
SCALE	AS NOTED
DRAWN	BTC
CHECKED	KHR
JOB	031-23
SHEET	

A-1.0

